

20 Waverley Gardens, Stamford, Lincs, PE9 1BH

This renovated and extended three bedroom home is located on the popular road of Waverley Gardens, just a short walk from Stamford town center, as well as being convenient for the A1.

The ground floor has been extensively renovated to create a large open plan kitchen living diner, with bifold doors opening on to the rear garden. In addition, there is a further reception room creating a separate office space or play room, as well as a convenient downstairs W/C.

To the first floor is a generous landing space leading to the three well proportioned bedrooms, alongside the modernised family bathroom.

Outside there is a garage and driveway parking for multiple cars and the enclosed rear garden with side access is part paved and laid to lawn.

£1,700 PCM

The particulars are set out as a general outline only for the guidance of intended purchasers or lessees, and do not constitute, any part of a contract. Nothing in these particulars shall be deemed to be a statement that the property is in good structural condition or otherwise nor that any of the services, appliances, equipment or facilities are in good working order. Purchasers should satisfy themselves of this prior to purchasing.

- Stunning open plan kitchen living area
- Refitted modern bathroom
- Popular road off of Casterton Road
- EPC: C Council Tax: C
- Available September 2025
- Seperate study/reception room
- Off street parking and garage
- Three well proportioned bedrooms
- Deposit: £1961 Holding Deposit: £392



ACCOMMODATION:

Entrance Hallway

Kitchen
4.78m x 4.78m (15'8" x 15'8")

Living area
7.87m x 3.66m (25'9" x 12'0")

Study
4.83m x 2.84m (15'10" x 9'3")

Downstairs W/C

First Floor Landing

Bedroom One
3.86m x 3.25m (12'7" x 10'7")

Bedroom Two
3.68m x 3.02m (12'0" x 9'10")

Bedroom Three
2.74m x 2.49m (8'11" x 8'2")

Bathroom

FLOOR PLAN:

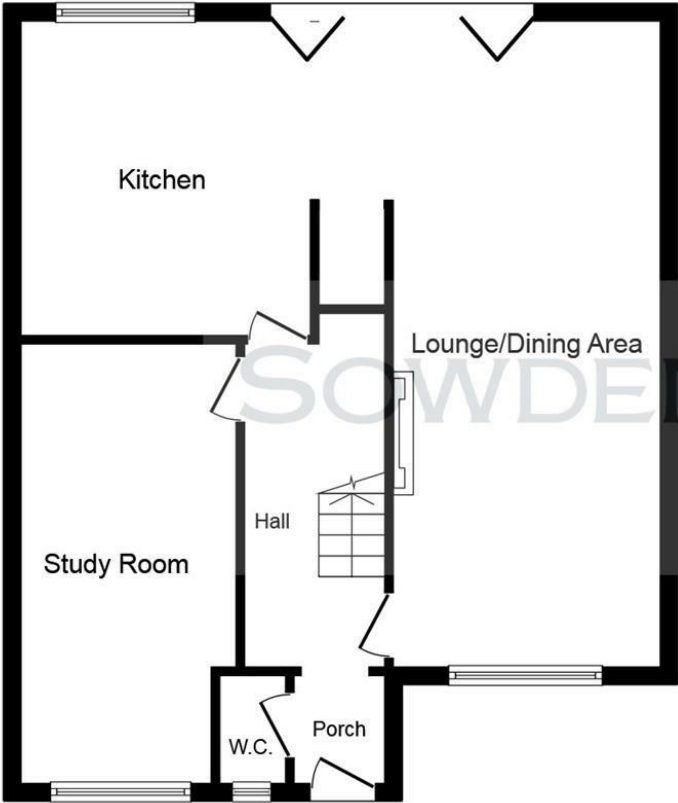

Ground Floor

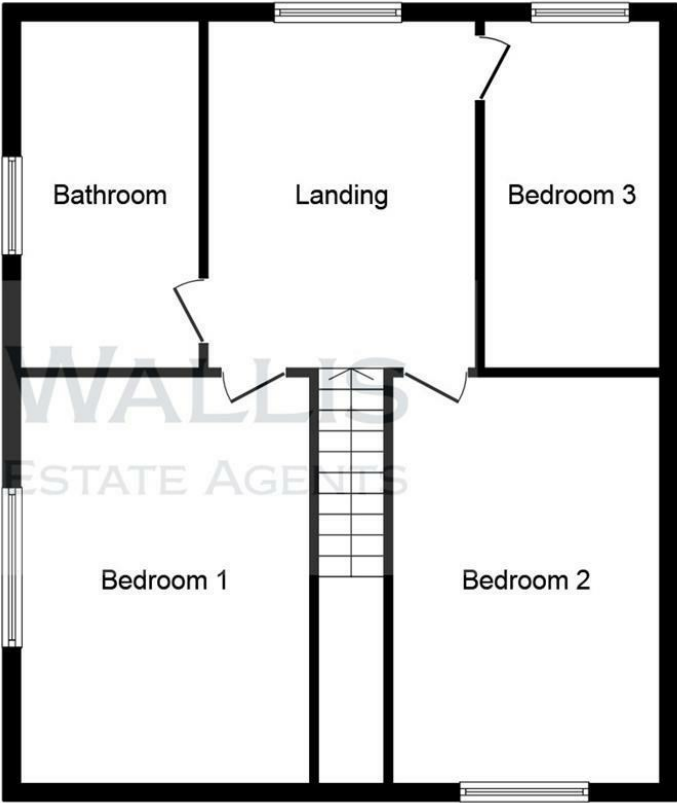

First Floor

This plan is for illustration purposes only and may not be representative of the property. Plan not to scale.